

**LEVITON**<sup>®</sup>  
decora smart<sup>®</sup>

# Getting Started Guide

---



Cat. No. DG6HD

WEB VERSION





# Welcome to the Decora Smart™ family of Zigbee® enabled devices



See the complete line of Zigbee enabled  
dimmers, switches and plug-ins  
[leviton.com/decorasmart](http://leviton.com/decorasmart)

WEB VERSION



## Welcome



The Decora Smart™ Dimmer with Zigbee® technology is designed for use with Zigbee hubs. Using mesh networking technology Zigbee provides quick, reliable, secure communication to a wide variety of smart products.

Add your dimmer to a Zigbee hub to control it with your smartphone or a voice interface.

### We are here to help



#### CALL

1-800-824-3005 (USA)  
1-800-405-5320 (Canada)



#### CHAT

[leviton.com](http://leviton.com)



#### ONLINE

[leviton.com/decorasmart](http://leviton.com/decorasmart)



#### EMAIL

[dssupport@leviton.com](mailto:dssupport@leviton.com)



## Your dimmer works with:

Your Decora Smart dimmer with Zigbee technology is compatible with dimmable LED, dimmable CFL, and incandescent bulbs. Your dimmer should not be used with electronic low voltage, motor loads or aluminum wire. To ensure proper communication do not use metal wallplates. For LED compatibility recommendations, go to [leviton.com/LED](http://leviton.com/LED).

Note: When two or more dimmers are installed next to each other the incandescent load rating becomes 500W for each dimmer. No reduction is necessary if the load is LED or CFL.



RATINGS	
LED / CFL	300W - 120VAC, 60Hz
Incandescent	600W - 120VAC, 60Hz
Operating Temp	0°C - 40°C (32°F - 104°F)
Operating Humidity	0-90% non-condensing
NETWORK	
Zigbee	Zigbee 3.0 Certified



## Features

### Rocker

Manually turn light on.  
The bottom of the paddle turns the light off.

### Brightness indicator lights

Displays light level when adjusting brightness.

### Status light

Illuminates when load is off.

### Air gap switch

This feature will stop power to the lights to replace a bulb. After servicing is complete, press the dim bright bar back into place for normal operation. Engage the air-gap switch by gently pulling the bottom of the dim/bright bar until the bottom lifts completely out of the frame and a click is heard. The dimmer brightness indicator lights and any connected lights will turn off.

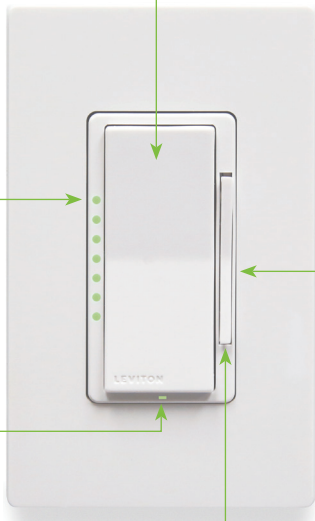

### Dim / bright bar

Manually adjust light levels.



## Before you install

### Things to consider:

- If light(s) are controlled from more than one location, you will need a DD00R remote. See the DD00R installation instructions for wiring instructions.



- Zigbee is a mesh network. It must be installed within 30 ft of hub or another Zigbee 3.0 compliant device.

**NOTE:** Communication through exterior surfaces will likely reduce transmission distances.

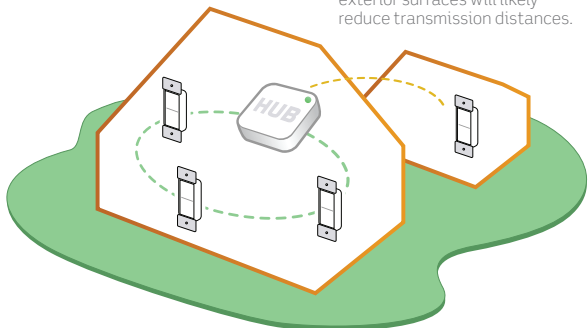



## Identify your wires

### Check your wall box:

**WARNING: TO AVOID FIRE, SHOCK OR DEATH, turn off power at the circuit breaker.**

1. Remove wallplate and disconnect switch.
2. Ensure disconnected wires are not touching.
3. Restore power. Carefully test wires with voltage tester to find the hot wire.
4. Turn off power at the circuit breaker.
5. Mark the following wires:

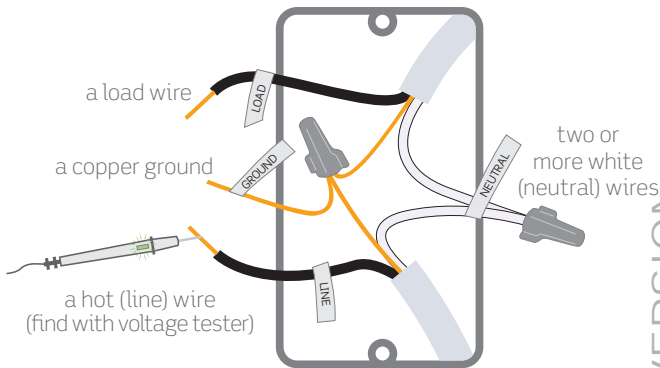

**If your wall box looks different,  
consult an electrician.**





## Wire your dimmer

1. Work on only one connection at a time.
2. Connect wires as shown.
3. Secure wire connections with an electrical connector.

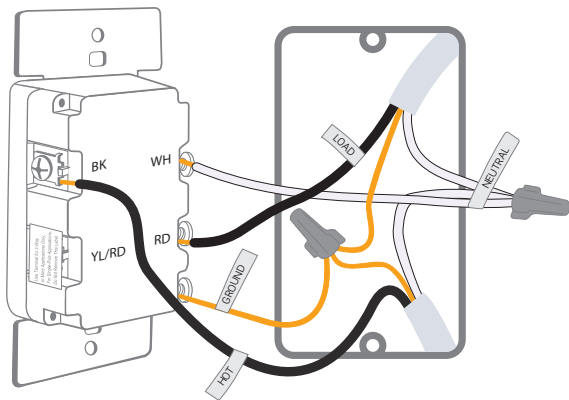

**If your wall box looks different,  
consult an electrician.**



## Test and install

1. Restore power. Status light should flash green indicating your dimmer is ready to join the network.

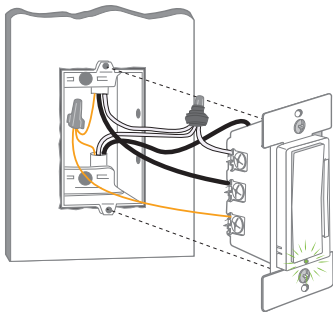

**Turn off power at circuit breaker before completing the dimmer installation.**

2. Gently push wires into wall box. Screw dimmer to box.

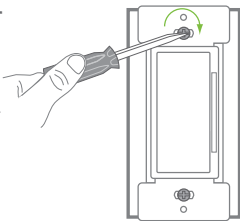

3. Install screwless wallplate base and snap on Decora wallplate. Restore power.

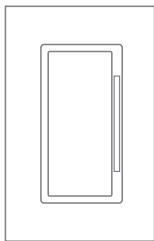

**Congratulations!**  
**Your Decora Smart dimmer**  
**is ready to control your light(s).**



## Operate and program

1. Manually control light levels with rocker or dimmer bar.
2. Program your dimmer.

### Set your dimmer's load type for proper operation.

1. Enter programming mode by holding the top of the paddle for 7 seconds.
  - Status light will turn amber.
2. Tap the top of the paddle 4 times.
  - Status light will quickly flash green/amber.
3. Tap the top of the paddle to choose your load type.

Tap: If your light is:

4 times = incandescent load

5 times = LED load

6 times = CFL load

- Status light will quickly flash green/amber 3 times.

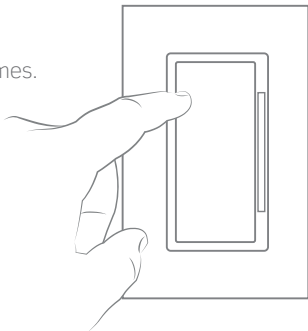

## Minimum dim level

The default dimmer settings work well with most lighting fixtures. If you are not experiencing full range dimming, please adjust the minimum dim level.

1. Enter programming mode by holding the top of the paddle for 7 seconds.
  - Status light will turn amber.
2. Tap the top of the paddle 5 times.
  - Status light will quickly flash red/amber.
3. Tap the top of the paddle once.
  - Status light will flash amber.
4. Use the dim/bright bar to adjust the minimum dim level.
5. Hold the top of the paddle to exit.

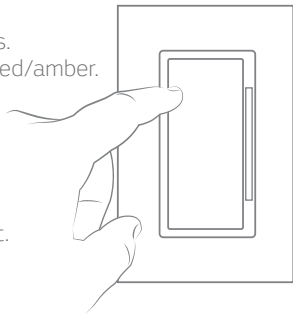

## Add your dimmer to a hub

To control your dimmer with your phone, add it to a compatible Zigbee hub. Use the hub's app and follow the instructions for adding a dimmer. When you power up your dimmer it immediately enters inclusion mode (some hubs may use the term connect, join or pair).

When joining multiple devices, the air gap can be used to ensure only one active device is enrolled.

If the hub uses older inclusion processes contact technical services for specific product instructions.



## Factory default

To reset dimmer to factory settings and place into joining mode:

1. Hold the top of the paddle for a total of 14 seconds.
2. After the first 7 seconds the light turns amber. Continue to hold.
3. After a total of 14 seconds, the status light will quickly flash red/amber.
4. Release the top of the paddle and the dimmer will reset.



## Manually start/stop joining

When you first power on your dimmer or perform a factory reset the green status light will automatically flash. This indicates the dimmer is in joining mode. It will remain in this state for 30 minutes or until the dimmer is added to a network. To manually start or stop joining mode, perform the following steps:

1. Hold the top of the paddle for 7 seconds. Status light will turn amber.
- 2a. To start joining mode tap the top of the paddle 1 time. The status light will flash green rapidly to indicate it is in joining mode.
- 2b. To stop joining mode tap the top of the paddle 1 time. The dimmer will leave joining mode.

**NOTE:** the device can still be operated manually even if not joined to a hub.



## Safety first

### **WARNING: TO AVOID FIRE, PERSONAL INJURY OR DEATH DO NOT USE**

the dimmer for the control of high power heating appliances such as portable heaters. There can be unexpected consequences if not used with care. For example, an empty coffee pot can be remotely turned on. If that should happen, your coffee pot could be damaged from overheating. If an electric heater is turned on by remote control while clothing is draped over it, a fire could result. This module will not control lighting that is used with electronic low-voltage and high frequency power supply transformers, nor high pressure discharge lamps (HID lighting). This includes mercury-vapor, sodium vapor and metal halide lamps.

### **WARNINGS:**

- To reduce the risk of overheating and possible damage to other equipment do not install to control a motor-operated appliance, fluorescent lighting fixture, or a transformer supplied appliance.
- This product is to be installed and/or used in accordance with electrical codes and regulations.
- Indoor use only.
- If you are unsure about any part of these instructions, consult an electrician.
- Turn off power at the circuit breaker when servicing.
- Save this instruction sheet. It contains important technical data along with testing and troubleshooting information which will be useful after installation is complete.

# Limited 5 year warranty

For Leviton's limited product warranty, go to [www.leviton.com](http://www.leviton.com). For a printed copy of the warranty, call 1-800-824-3005.

## FOR CANADA ONLY

For warranty information and/or product returns, residents of Canada should contact Leviton in writing at Leviton Manufacturing of Canada Ltd to the attention of the Quality Assurance Department, 165 Hymus Blvd, Pointe-Claire (Quebec), Canada H9R 1E9 or by telephone at 1-800-405-5320.

## FCC COMPLIANCE STATEMENT

The enclosed device complies with Part 15 of the FCC Rules. Operation is subject to the following two conditions: (i) This device may not cause harmful interference (ii) This device must accept any interference received, including interference that may cause undesired operation. Any changes or modifications not expressly approved by Leviton could void the user's authority to operate this equipment. This equipment has been tested and found to comply with the limits for a Class B digital device, pursuant to part 15 of the FCC Rules. These limits are designed to provide reasonable protection against harmful interference in a residential installation. This equipment generates uses and can radiate radio frequency energy and, if not installed and used in accordance with the instructions, may cause harmful interference to radio communications. However, there is no guarantee that interference will not occur in a particular installation. If this equipment does cause harmful interference to radio or television reception, which can be determined by turning the equipment off and on, the user is encouraged to try to correct the interference by one or more of the following measures:

- Reorient or relocate the receiving antenna.
- Increase the separation between the equipment and receiver.
- Connect the equipment into an outlet on a circuit different from that to which the receiver is connected.
- Consult the dealer or an experienced radio/TV technician for help.

## FCC CAUTION

Any changes or modifications not expressly approved by Leviton Manufacturing Co., Inc., could void the user's authority to operate the equipment.

## FCC SUPPLIER'S DECLARATION OF CONFORMITY:

Model DG6HD - Dimmer is manufactured by Leviton Manufacturing Co., Inc., [www.leviton.com](http://www.leviton.com).

This device complies with part 15 of the FCC Rules. Operation is subject to the following two conditions: (1) This device may not cause harmful interference, and (2) this device must accept any interference received, including interference that may cause undesired operation.

## IC STATEMENT

This device complies with Industry Canada license-exempt RSS standard(s). Operation is subject to the following two conditions: (1) this device may not cause interference, and (2) this device must accept any interference, including interference that may cause undesired operation of the device.

## RF EXPOSURE AND CO-LOCATION:

To comply with FCC OET Bulletin 65 and ICSED RF exposure limits for general population and uncontrolled exposure, this device shall be installed and operated with a minimum distance of 7.9 inches (20 cm) between the radiator and your body. Also, must not be co-located or operated in conjunction with any other antenna or transmitter.

### Copyright and Trademark Information

The Leviton logo and Decora Smart are trademarks of Leviton Manufacturing Co., Inc. Zigbee is a U.S. registered trademark of Zigbee Alliance. Use herein of other third party trademarks, service marks, trade names, brand names and/or product names are for informational purposes only, are/may be the trademarks of their respective owners; such use is not meant to imply affiliation, sponsorship, or endorsement. No part of this document may be reproduced, transmitted or transcribed without the express written permission of Leviton Manufacturing Co., Inc.

Copyright 2020 Leviton Mfg. Co., Inc.

# If you need help...



## CALL

1-800-824-3005 (USA)

1-800-405-5320 (Canada)



## ONLINE

[leviton.com/decorasmart](http://leviton.com/decorasmart)



## CHAT

[leviton.com](http://leviton.com)



## EMAIL

[dssupport@leviton.com](mailto:dssupport@leviton.com)

Leviton Manufacturing Co., Inc.  
201 North Service Road, Melville, NY 11747  
Telephone: 1-800-824-3005

Visit Leviton's website at [www.leviton.com](http://www.leviton.com)  
© 2020 Leviton Manufacturing Co., Inc. All rights reserved.

Specifications subject to change at any time without notice.

DI-000-DG6HD-02A

WEB VERSION